

Vista Fusion

- Vibrant neon look without hot spots, 240 LEDs/m
- Available in 8 distinct colors and 3 finishes
- Different mounting options available – shown below
- Tips available for finished look
- Available in 12 Vdc and 24 Vdc operating voltages
- Operating temperature: -20C to 45C
- Designed for interior and exterior applications, IP66 / IP67 rated
- UV compliant with ASTM G154
- Salt Spray compliant with ASTM B117
- UL approved / ROHS Compliant
- Compatible with plastic tips: #580819 (black) and #580821 (chrome)
- Compatible with plastic clip: #981xxx (clear) and #981xxx (black)



DIMENSIONS

PLEASE NOTE THAT THIS PRODUCT IS IN A PRELIMINARY STATE AND IS SUBJECT TO POTENTIAL CHANGE BEFORE FULL RELEASE.

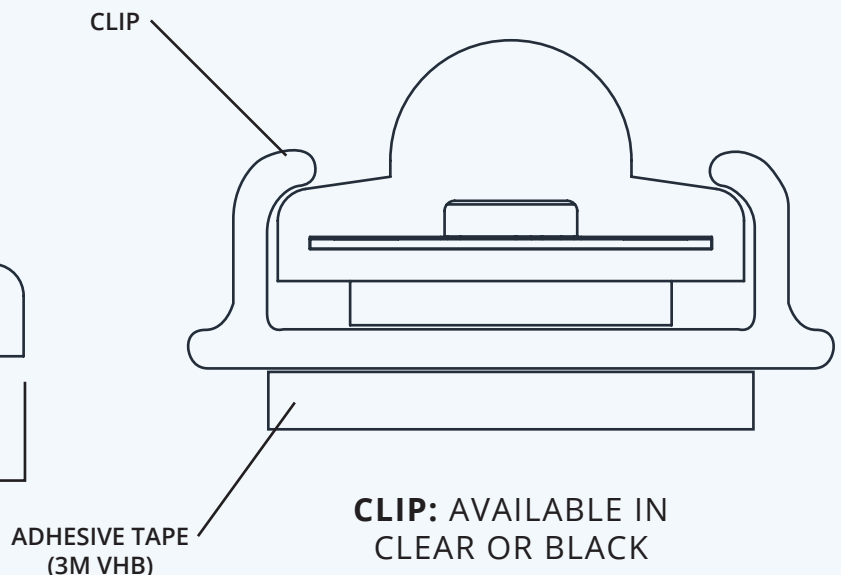
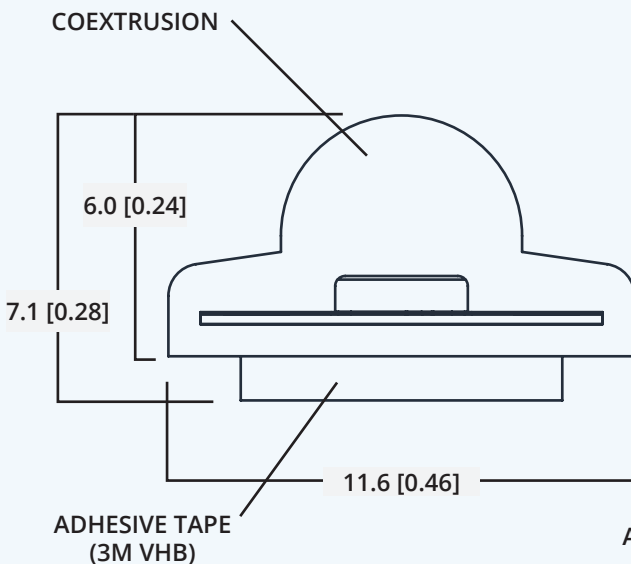

SPECIFICATIONS

SPECIFICATIONS														
PART NUMBER	VOLTAGE	CURRENT (MA/FT)	WATTAGE (W MAX/FT)	SILICONE COLOR		LED COLOR	CCT (K)/WAVE-LENGTH(NM)	LUMINOUS FLUX						
				DIFFUSER	FLANGES									
461497	12	183	2.9	DIFFUSED WHITE	WHITE	WARM WHITE	3000 K	TBD						
462498						RED	623							
463497						AMBER	591							
464497						NATURAL WHITE	4500 K							
465497						GREEN	523							
466497						BLUE	465							
467497						PURPLE	415							
468497						COOL WHITE	6000 K							
461501						SMOKE	BLACK		WARM WHITE	3000 K				
462502									RED	623				
463501				AMBER	591									
464501				NATURAL WHITE	4500 K									
465501				GREEN	523									
466501				BLUE	465									
467501				PURPLE	415									
468501				COOL WHITE	6000 K									
461505				BLACK	BLACK				WARM WHITE	3000 K				
462506									RED	623				
463505						AMBER	591							
464505						NATURAL WHITE	4500 K							
465505						GREEN	523							
466505						BLUE	465							
467505						PURPLE	415							
468505						COOL WHITE	6000 K							
461499						24	91		2.3	DIFFUSED WHITE	WHITE	WARM WHITE	3000 K	TBD
462500												RED	623	
463499				AMBER	591									
464499				NATURAL WHITE	4500 K									
465499	GREEN	523												
466499	BLUE	465												
467499	PURPLE	415												
468499	COOL WHITE	6000 K												
461503	SMOKE	BLACK	WARM WHITE	3000 K										
462504			RED	623										
463503			AMBER	591										
464503			NATURAL WHITE	4500 K										
465503			GREEN	523										
466503			BLUE	465										
467503			PURPLE	415										
468503			COOL WHITE	6000 K										
461507			BLACK	BLACK	WARM WHITE			3000 K						
462508					RED			623						
463507	AMBER	591												
464507	NATURAL WHITE	4500 K												
465507	GREEN	523												
466507	BLUE	465												
467507	PURPLE	415												
468507	COOL WHITE	6000 K												

Vista reserves the right to modify this specification without prior notice.

TIP: AVAILABLE IN CHROME OR BLACK FINISH

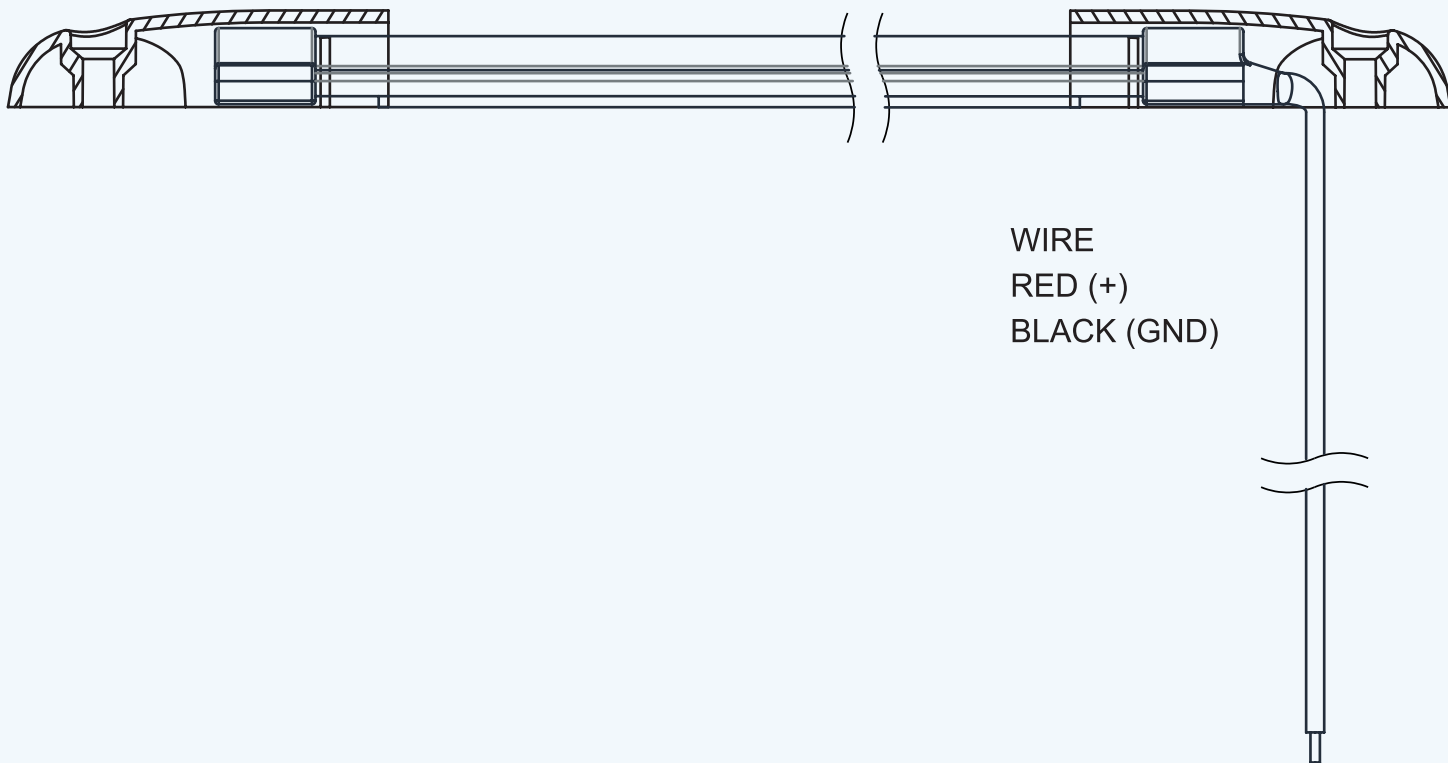
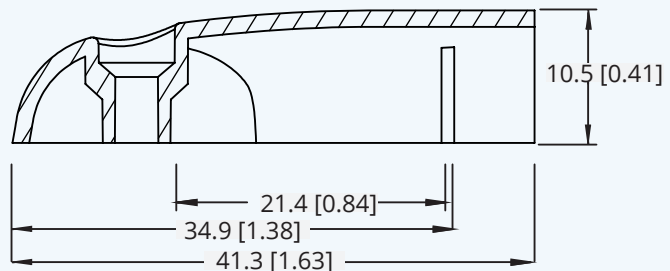

Vista reserves the right to modify this specification without prior notice.

INSTALLATION INSTRUCTIONS FOR LINEAR LIGHTS

PRODUCT IDENTIFICATION

Determine the mount type of your linear light

- Adhesive - Full length or intermittent adhesive attached to the bottom of the extrusion profile.
- Clips - Short-length press-in clips, mounted with fasteners, that allow routing of a light in a non-linear fashion.
- Channel - Full length rigid or semi-rigid channel, mounted with fasteners, available with adhesive backing for temporary hold. Some channel products come with finishing tips which contain a fastener location or pre-drilled support holes inside of the channel for fasteners. Other channels must be pre-drilled prior to fastening to the mount surface.

PREPARATION

Prepare the mount surface in accordance with your fastener type:

- Adhesive – It is recommended to use an adhesive promoter in order to increase the bond strength for all types of adhesive tape (adhesive promoter not included). If an adhesive promoter is not available, prep the mount surface with isopropyl alcohol to increase bond strength. Make sure that while mounting flexible lights, a bend radius smaller than the minimum bend radius of your selected product is not applied. Mounting flexible lights beyond the minimum bend radius will void warranty.
- Clips – When setting up clip locations for lights in a non-linear fashion, make sure that the clip locations will not produce a bend radius smaller than the minimum bend radius of your selected product. Mounting flexible lights beyond the minimum bend radius will void warranty.
- Channel – If the channel has an adhesive backing follow the preparation instructions for adhesives above. If the channel has finishing tips, make sure that the full assembly will fit in the intended mounting location. Channels should be mounted on a flat surface to ensure that light extrusions will remain secure. If holes are not already predrilled into the channel, locate and drill the mounting holes now. It is recommended to have a mount hole at least every 9”.

FASTENING: Using product appropriate fasteners, mount the light to your desired surface. It is up to the installer to ensure the proper fasteners are used for the application mount surface. Mechanical fasteners supplied by Vista are generic fasteners. If these are not appropriate for the intended mount surface, a customer supplied fastener should be identified and used.

- Adhesive only – After preparation, peel away the adhesive backer. It is recommended for long, non-linear applications, that the adhesive backer is removed in sections so that the light can be routed without accidental adhesion. After initial adhesion, apply pressure evenly throughout the adhered surface for at least 30 seconds. All adhesive mounted products should be allowed 24 hours of cure time before being acted upon by an outside force to ensure best adhesion.
- Clips – pre-drill clips (if not already done) and locate them along the mount surface, keeping in mind not to exceed the minimum bend radius of the selected product. After clips are located and mounted, route the light extrusion through the clips by pressing until the fastening mechanism of the clip is engaged.
- Channel – Remove the light extrusion from the channel if already assembled. If the channel selected has adhesive, determine the required mounting position of the light and peel away the adhesive backer. Apply the channel to the mount location and apply pressure evenly throughout the adhered surface for at least 30 seconds. This is intended to be a temporary adhesion. Apply fasteners into the pre-drilled holes inside of the channel for permanent fixturing. The holes located nearest each end of the channel are meant for wire routing and finishing tips see Figure 1. Do not apply fasteners to these holes. Drill a hole through the mounting surface in the proper location for wire routing if necessary. Make sure that if there are finishing tips and the wires are routed straight out of the end of the extrusion, the wire routing hole will not interfere with the screw mounting of the finishing tip. Press or slide the light extrusion into the channel, Apply finishing tips to channel (if applicable) routing wires through if necessary.

DISCONNECT POWER SOURCE (BATTERY) BEFORE STARTING ELECTRICAL WORK.

Recommended methods for splicing wires together (parts not included in Vista product kits):

- Solder and cover bare wires with heat shrink or electrical tape.
- Insulation-displacement connector (IDC) / insulation-piercing contact (IPC).
- Twist on wire connector, “wire nut”.
- Crimp connector, “Butt splice”.

Vista reserves the right to modify this specification without prior notice.

WIRING:

Route wire as necessary for the application. Do not pinch or puncture wires with fasteners. Do not route wires around sharp edges. A wire loom should be used for protection if wires are to be routed through areas where they may encounter sharp edges, in an application that would experience high amounts of vibration, in areas that may have fasteners protruding into them during later assembly, or other extreme conditions. Standard wiring outputs can be seen below.

Vista Standard RGB Lighting Wire Colors – Due to product variation, the wire colors for some Vista RGB lights may vary depending on the product. Refer to the following wire polarity information for Vista RGB Lighting.

SINGLE COLOR LIGHTS

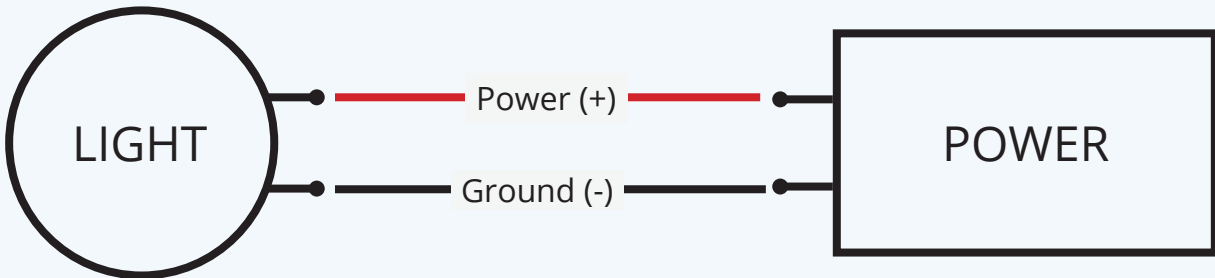

WARNING:

1. Supply current and wattage must not exceed the rated values on the specification documents.
2. Incorrect polarity or improper wiring may cause personal injury and/or damage to the product. It is recommended that an electrical technician, professional, or similarly qualified individual finish wiring.
3. To avoid electrical shock risk, all failures should be examined by a qualified technician.
4. Environmental suitability, including but not limited to water resistance, varies based on product design. Unless explicitly noted, products are to be installed in a location shielded from outdoor elements. To avoid irreparable damage, refer to specification sheets to locate products in a proper environment.
5. Do not install products near an open flame or in high temperature environments unless the product is explicitly designed to function as such. Adversely, do not install products in excessively cold environments unless explicitly designed to function as such. Refer to product spec sheets/drawings for information about minimum and maximum operating temperatures.
6. Vista Manufacturing, Inc. is not liable for any injuries or damage caused due to improper wiring or installation.
7. Only use the provided power supply or a Class 2 equivalent when wiring lights.
8. The listed IP Rating on products applies to the lighted assembly and installed connectors. If a product has an open wire to allow for hardwiring or installing aftermarket connectors, assume the IP rating at the open wire point is no higher than IP20.
9. Do not use cutting tools such as wire cutters, scissors, or shears to separate wire. Wires should be pulled apart in shear, perpendicular to the flat plane of the wire ribbon, and not in tension.

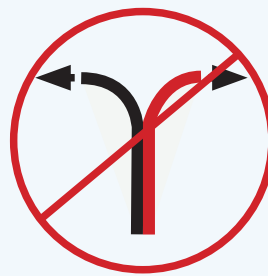
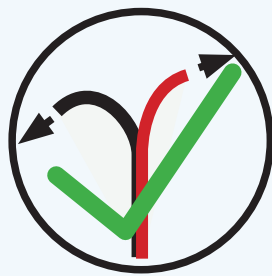

Vista reserves the right to modify this specification without prior notice.